

## Quick Installation Guide

Dual-Band Gigabit Wi-Fi 6 Router  
X2LR Pro/X12LR Pro



Get Support  
and Services

Scan the QR code or visit [www.ip-com.com.cn](http://www.ip-com.com.cn) for installation videos, technical specifications, user guides and more information.

You can see the product name and model on the product label.  
The label can be found on the back of the device.

### Package Contents

- Wireless router x 1
- Power adapter x 1
- Ethernet cable x 1
- Quick installation guide

## Scenario 1: Set up the device as a router

### I. Connect the router

The product appearance may vary with models. Please refer to the product you purchased.

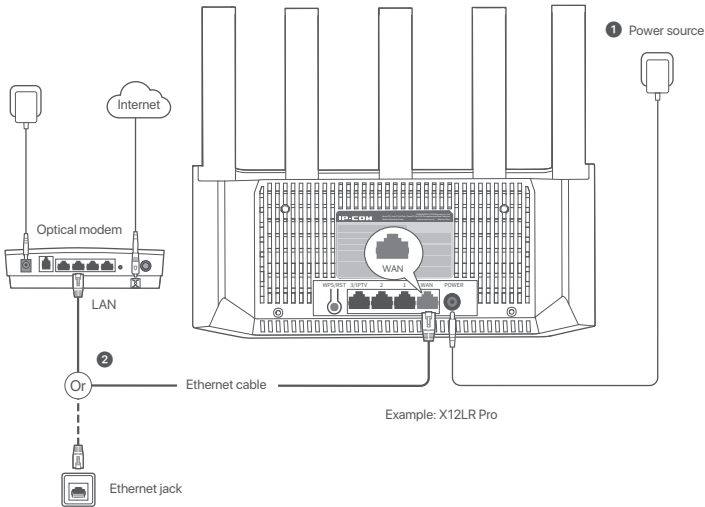

#### Tips

- If you use the modem for internet access, power off the modem first before connecting the WAN port of the router to the LAN port of your modem and power it on after the connection.
- Refer to the following relocation tips to locate the router to a proper position:
  - Place the router in a high position with few obstacles.
  - Keep your router away from electronics with strong interference, such as microwave ovens, induction cookers, and refrigerators.
  - Keep your router away from metal barriers, such as weak current boxes, and metal frames.

- Power on the router.
- Connect the WAN port of the router to the LAN port of your modem or the Ethernet jack using an Ethernet cable.

### II. Connect the router to the internet

- Connect your wireless client such as a smartphone to the WiFi network of the router, or use an Ethernet cable to connect the computer to the LAN port of the router. The WiFi name can be found on the label of the router's body.
- After the client connects to the router, the page will automatically redirect to the web UI of the router. If not, start a web browser on your client and enter **ipcwifi.com** in the address bar to access the router's web UI.



- Perform operations as prompted (smartphone used as an example).

- Tap **Start**.

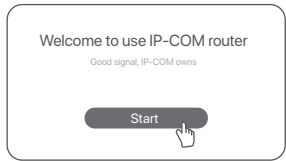

- The router detects your connection type automatically.

- If your internet access is available without further configuration (for example, PPPoE connection through an optical modem is completed), tap **Next**.

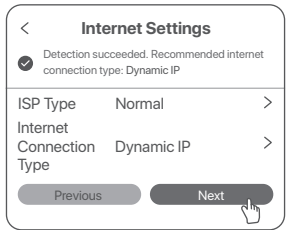

## Scenario 2: Set up as an add-on node



#### Tips

- This router can be networked with **IP-COM WiFi+** routers.
- Ensure that the existing router (primary node) has been connected to the internet and the router (secondary node) to be added has never been used. If not, reset this router first.
- Two X12LR Pro are used as an example here. If the router fails to be added to an existing network, contact IP-COM customer service for help.

### I. Add the router to an existing network

- Place the router in an elevated and open position within 3 meters from your existing router.
- Use the power adapter to connect the router to a power source.
- Press the **WPS** button of the router for about 1-3 seconds. The indicator blinks green quickly. Within 2 minutes, press the **WPS** button of the existing router for 1-3 seconds to negotiate with this router.

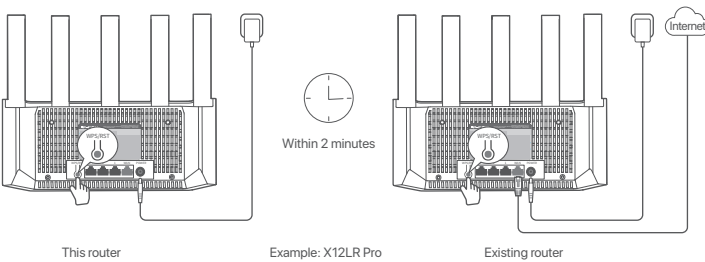

When the indicator of the router lights solid green, the networking is successful and the router becomes a secondary node in the network.

### II. Relocate the router

- Refer to the following relocation tips to locate the router to a proper position:

- Ensure that the distance between any two nodes is less than 10 meters.
- Keep your routers away from electronics with strong interference, such as microwave ovens, induction cookers, and refrigerators.
- Place the routers in a high position with few obstacles.

- Power on the router again.

- Wait 1-2 minutes and observe the router's indicator. If the indicator is solid green, the connection between the primary node and secondary node is good. Otherwise, move the router (secondary node) closer to the existing router for better connection quality.

- Done.

To access the internet with:

- WiFi-enabled devices: Connect to your WiFi network. (The WiFi name and WiFi password of the new router are the same as the existing router.)
- Wired devices: Connect to a LAN port of the router using an Ethernet cable.

- If the PPPoE user name and password are required for internet access, select the **ISP Type** based on your region and ISP and enter required parameters (if any). If you forget your PPPoE user name and password, you can obtain the PPPoE user name and password from your ISP and manually enter them. Then, tap **Next**.

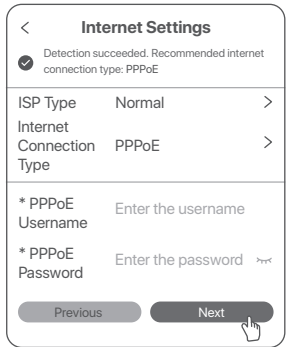

- Set the WiFi name, WiFi password and login password for the router. Tap **Next**.

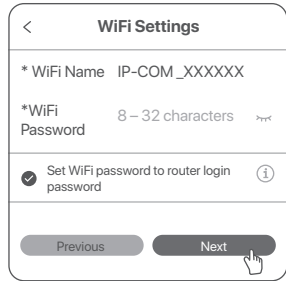

#### Tips

The WiFi password is used to connect to the WiFi network, while the login password is used to log in to the web UI of the router.

## Indicator



Example: X12LR Pro

Indicator	Scenario		Status	Description
Indicator	Startup		Solid green	The system is starting up.
	Internet connection	Primary node	Solid green	The router is connected to the internet.
			Blinking green slowly	Not configured and the router is not connected to the internet.
			Blinking red slowly	Configured but the router failed to connect to the internet.
			Blinking orange slowly	Configured but no Ethernet cable is connected to the WAN port.
		Secondary node	Solid green	Networking succeeds. Good connection quality.
			Solid orange	Networking succeeds. Fair connection quality.
			Solid red	Networking succeeds. Poor connection quality.
			Blinking green slowly	Waiting to connect to another node.
		Blinking red slowly	Configured but the router failed to connect to the internet.	
	WPS		Blinking green quickly	Pending for or performing WPS negotiation (valid within 2 minutes)
	Ethernet cable connection		Blinking green quickly for 3 seconds	A device is connected to or disconnected from an Ethernet port of the router.
	PPPoE user name and password importing (only for primary node)		Blinking green quickly for 8 seconds	PPPoE user name and password are imported successfully.
	Resetting		Blinking orange quickly	Restoring to factory settings.

# Jack, ports and buttons

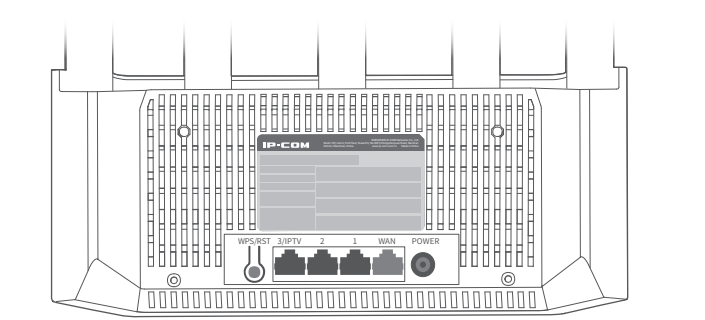

Example: X12LR Pro	
Jack/Port/Button	Description
WPS/RST	Used to start the WPS negotiation process, or to reset the router. – <b>WPS:</b> Through the WPS negotiation, you can connect to the WiFi network of the router without entering the password. <b>Method:</b> Press the button 1-3 seconds, and the indicator blinks green fast. Within 2 minutes, enable the WPS function of the other WPS-supported device to establish a WPS connection. – <b>Mesh:</b> When it is used as a Mesh networking button, you can extend your network with another device that supports the Mesh function. <b>Method:</b> Press this button for about 1-3 seconds. The indicator blinks green fast, which indicates the device is searching for another device to form a network. Within 2 minutes, press the MESH/WPS button of another device for 1-3 seconds to negotiate with this device. – <b>Reset method:</b> Refer to <b>Q3</b> in <b>FAQ</b> .
3/IPTV	Gigabit LAN/IPTV port. It is a LAN port by default. When the IPTV function is enabled, it can only serve as an IPTV port to connect to a set-top box.
2, 1	Gigabit LAN port. Used to connect to such devices as computers, switches and game machines.
WAN	Gigabit WAN port. Used to connect to a modem or the Ethernet jack for internet access.
POWER	Power jack.



### RECYCLING

This product bears the selective sorting symbol for Waste electrical and electronic equipment (WEEE). This means that this product must be handled pursuant to European directive 2012/19/EU in order to be recycled or dismantled to minimize its impact on the environment.  
User has the choice to give his product to a competent recycling organization or to the retailer when he buys a new electrical or electronic equipment.



### FCC Statement

This equipment has been tested and found to comply with the limits for a Class B digital device, pursuant to Part 15 of the FCC Rules. These limits are designed to provide reasonable protection against harmful interference in a residential installation. This equipment generates, uses and can radiate radio frequency energy and, if not installed and used in accordance with the instructions, may cause harmful interference to radio communications. However, there is no guarantee that interference will not occur in a particular installation. If this equipment does cause harmful interference to radio or television reception, which can be determined by turning the equipment off and on, the user is encouraged to try to correct the interference by one or more of the following measures:

- Reorient or relocate the receiving antenna.
- Increase the separation between the equipment and receiver.
- Connect the equipment into an outlet on a circuit different from that to which the receiver is connected.
- Consult the dealer or an experienced radio/TV technician for help.

Operation is subject to the following two conditions: (1) this device may not cause harmful interference, and (2) this device must accept any interference received, including interference that may cause undesired operation.

The device is for indoor usage only.

### Radiation Exposure Statement

This device complies with FCC radiation exposure limits set forth for an uncontrolled environment and it also complies with Part 15 of the FCC RF Rules.

This equipment should be installed and operated with minimum distance 20cm between the device and your body.

### Caution:

Any changes or modifications not expressly approved by the party responsible for compliance could void the user's authority to operate this equipment.

This transmitter must not be co-located or operating in conjunction with any other antenna or transmitter.  
Operating frequency: 2412-2462 MHz 5150-5250 MHz (X2LR Pro) 5150-5350 MHz (X12LR Pro) 5725-5825 MHz

**NOTE:** (1) The manufacturer is not responsible for any radio or TV interference caused by unauthorized modifications to this equipment. (2) To avoid unnecessary radiation interference, it is recommended to use a shielded RJ45 cable.

# FAQ

### Q1: I cannot log in to the web UI by visiting ipcwifi.com. What should I do?

**A1:** Try the following solutions:

- Ensure that your smartphone or computer is connected to the WiFi network of the router.
  - For the first login, connect the WiFi name (IP-COM\_XXXXXX) on the label of the device's body. XXXXXX is the last six digits of the MAC address on the label.
  - When logging in again after setting, use the changed WiFi name and password to connect to the WiFi network.
- If you are using a smartphone, ensure that the cellular network (mobile data) of the client is disabled.
- If you are using a wired device, such as a computer:
  - Ensure that **ipcwifi.com** is entered correctly in the address bar, rather than the search bar of the web browser.
  - Ensure that the computer is set to **Obtain an IP address automatically** and **Obtain DNS server address automatically**.

If the problem persists, reset the router by referring to **Q3** and try again.

### Q2: I cannot access the internet after the configuration. What should I do?

**A2:** Try the following solutions:

- Ensure that the WAN port of the router is connected to a modem or Ethernet jack properly.
- Log in to the web UI of the router and navigate to the **Internet Settings** page. Follow the instructions on the page to solve the problem.

If the problem persists, try the following solutions:

- For WiFi-enabled devices:
  - Ensure that your devices are connected to the WiFi network of the router.
  - Visit **ipcwifi.com** to log in to the web UI and change your WiFi name and WiFi password on the **WiFi Settings** page. Then try again.
- For wired devices:
  - Ensure that your wired devices are connected to a LAN port properly.
  - Ensure that wired devices are set to **Obtain an IP address automatically** and **Obtain DNS server address automatically**.

### Q3: How to restore my device to factory settings?

**A3:** When your device is working properly, hold down the reset (marked **RST** or **Reset**) button of your device for about 8 seconds, and release it when the indicator blinks orange fast. After about 1 minute, the router is reset successfully and rebooted. You can configure the router again.

### Q4: The router's Wi-Fi signal is poor. What should I do?

**A4:** Try the following solutions:

- Place the router in a high position with few obstacles.
- Keep your router away from electronics with strong interference, such as microwave ovens, induction cookers, and refrigerators.
- Keep your router away from metal barriers, such as weak current boxes, and metal frames.

	AT	BE	BG	CH	CY	CZ	DE	DK	EE	EL	ES	FI	FR	HR	HU	IE
	IS	IT	LI	LT	LU	LV	MT	NL	NO	PL	PT	RO	SE	SI	SK	UK(NI)

**English-Attention:** In EU member states, EFTA countries, Northern Ireland and Great Britain, the operation in the frequency range 5150MHz-5350MHz (X12LR Pro) and 5150MHz-5250MHz (X2LR Pro) is only permitted indoors.

**Polski-Uwaga:** W państwach członkowskich UE, krajach Europejskiego Stowarzyszenia Wolnego Handlu (EFTA), Irlandii Północnej i Wielkiej Brytanii praca w zakresie częstotliwości 5150MHz-5350MHz (X12LR Pro) i 5150MHz-5250MHz (X2LR Pro) jest dozwolona tylko w pomieszczeniach.

**Deutsch-Achtung:** In den EU-Mitgliedsstaaten, den EFTA-Ländern, Nordirland und Großbritannien ist der Betrieb im Frequenzbereich 5150MHz-5350MHz (X12LR Pro) und 5150MHz-5250MHz (X2LR Pro) nur in Innenräumen erlaubt.

**Français-Attention:** Dans les États membres de l'UE, les pays de l'AELE, l'Irlande du Nord et la Grande-Bretagne, l'utilisation dans la gamme de fréquences 5150MHz-5350MHz (X12LR Pro) et 5150MHz-5250MHz (X2LR Pro) n'est autorisée qu'en intérieur.

**Nederlands-Aandacht:** In de EU-lidstaten, de EVA-landen, Noord-Ierland en Groot-Brittannië is gebruik in het 5150MHz-5350MHz (X12LR Pro) en 5150MHz-5250MHz (X2LR Pro) frequentiebereik alleen binnenshuis toegestaan.

**Čeština-Pozor:** V členských státech EU, zemích ESVO, Severním Írsku a Velké Británii je provoz ve frekvenčním rozsahu 5150MHz-5350MHz (X12LR Pro) a 5150MHz-5250MHz (X2LR Pro) povolen pouze v interiéru.

**Română-Atenție:** În statele membre UE, țările EFTA, Irlanda de Nord și Marea Britanie, operarea în intervalul de frecvență 5150MHz-5350MHz (X12LR Pro) și 5150MHz-5250MHz (X2LR Pro) este permisă numai în interior.

**Português-Atenção:** Nos estados membros da UE, países da EFTA, Irlanda do Norte e Grã-Bretanha, o funcionamento na gama de frequências 5150MHz-5350MHz (X12LR Pro) e 5150MHz-5250MHz (X2LR Pro) só é permitido no interior.

**Svenska-Uppmärksamhet:** I EU medlemsstater, EFTA - länderna, Nordirland och Storbritannien är det endast tillåtet att använda frekvensområdet 5150MHz-5350MHz (X12LR Pro) MHz och 5150MHz-5250MHz (X2LR Pro) inomhus.

**Slovenský-Pozor:** V členských štátoch EÚ, krajinách EFTA, Severnom Írsku a Veľkej Británie je prevádzka vo frekvenčnom pásme 5150MHz-5350MHz (X12LR Pro) a 5150MHz-5250MHz (X2LR Pro) povolená len v interiéri.

**Ελληνικά-Προσοχή:** Στα κράτη μέλη της ΕΕ, στις χώρες της ΕΖΕΣ, στη Βόρεια Ιρλανδία και στη Μεγάλη Βρετανία, η λειτουργία στην περιοχή συχνοτήτων 5150MHz-5350MHz (X12LR Pro) a 5150MHz-5250MHz (X2LR Pro) επιτρέπεται μόνο σε εσωτερικούς χώρους.

**Magyar-Figyelem:** Az EU-tagállamokban, az EFTA-országokban, Észak-Írországban és Nagy-Britanniában az 5150MHz-5350MHz (X12LR Pro) zés az 5150MHz-5250MHz (X2LR Pro)-es frekvenciatarományban való működtetés csak beltérben engedélyezett.

**Italiano-Attenzione:** Negli Stati membri dell'UE, nei Paesi EFTA, nell'Irlanda del Nord e in Gran Bretagna, il funzionamento nella gamma di frequenze 5150MHz-5350MHz (X12LR Pro) e 5150MHz-5250MHz (X2LR Pro) è consentito solo in ambienti chiusi.

**Български-Внимание:** В страните-членки на ЕС, страните от ЕАСТ, Северна Ирландия и Великобритания, работата в честотния диапазон 5150MHz-5350MHz (X12LR Pro) и 5150MHz-5250MHz (X2LR Pro) е разрешена само на закрито.

**Español-Atención:** En los estados miembros de la UE, los países de la AELC, Irlanda del Norte y Gran Bretaña, el rango de frecuencia operativa de 5150MHz-5350MHz (X12LR Pro) y 5150MHz-5250MHz (X2LR Pro) solo está permitido en interiores.

# Safety Precautions

Before operating, read the operation instructions and precautions to be taken, and follow them to prevent accidents. The warning and danger items in other documents do not cover all the safety precautions that must be followed. They are only supplementary information, and the installation and maintenance personnel need to understand the basic safety precautions to be taken.

- The device is for indoor usage only.
- The device must be horizontally mounted for safe use.
- Do not use the device in a place where wireless devices are not allowed.
- Please use the included power adapter.
- The mains plug is used as the disconnect device, and shall remain readily operable.
- The power socket shall be installed near the device and easily accessible.
- Operating environment: Temperature: 0°C – 40°C (32°F - 104°F); Humidity: (10% – 90%) RH, non-condensing; Storage environment: Temperature: -40°C - 70°C (-40°F - 158°F); Humidity: (5% – 90%) RH, non-condensing.
- Keep the device away from water, fire, high electric field, high magnetic field, and inflammable and explosive items.
- Unplug this device and disconnect all cables during lightning storms or when the device is unused for long periods.
- Do not use the power adapter if its plug or cord is damaged.
- If such phenomena as smoke, abnormal sound or smell appear when you use the device, immediately stop using it and disconnect its power supply, unplug all connected cables, and contact the after-sales service personnel.
- Disassembling or modifying the device or its accessories without authorization voids the warranty, and might cause safety hazards.
- Refer all servicing to qualified service personnel.
- Disconnect the power source during servicing.
- Keep this device out of reach of children to prevent children from using it as a toy and causing personal injury.
- The device's marking information can be found on its surface.

For the latest safety precautions, see **Safety and Regulatory Information** on **www.ip-com.com.cn**.

# CE

### CE Mark Warning

This is a Class B product. In a domestic environment, this product may cause radio interference, in which case the user may be required to take adequate measures.

This equipment should be installed and operated with a minimum distance 20cm between the device and your body.

**NOTE:** (1) The manufacturer is not responsible for any radio or TV interference caused by unauthorized modifications to this equipment. (2) To avoid unnecessary radiation interference, it is recommended to use a shielded RJ45 cable.

### Declaration of Conformity

Hereby, SHENZHEN IP-COM NETWORKS CO., LTD. declares that the device (Router) is in compliance with Directive 2014/53/EU. The full text of the EU Declaration of Conformity is available at the following internet address: <http://ip-com.com.cn/en/ce.html>

### Operating frequency/Max output power

<b>English:</b> Operating Frequency/Max Output Power <b>Deutsch:</b> Betriebsfrequenz/Max. Ausgangsleistung <b>Italiano:</b> Frequenza operativa/Potenza di uscita massima <b>Español:</b> Frecuencia operativa/Potencia de salida máxima <b>Português:</b> Frequência de Funcionamento/Potência Máxima de Saída <b>Français:</b> Fréquence de fonctionnement/Puissance de sortie maximale <b>Nederlands:</b> Bedrijfsfrequentie/Maximaal uitgangsvermogen <b>Svenska:</b> Driftsfrekvens/Max Uteffekt <b>Dansk:</b> Driftsfrekvens/Maks. Udgangseffekt <b>Suomi:</b> Toimintataajuus/maksimálilähtöteho <b>Magyar:</b> Működési frekvencia/Maximális kimeneti teljesítmény <b>Polski:</b> Częstotliwość pracy / Maksymalna moc wyjściowa <b>Русский:</b> Рабочая частота/макс. выходная мощность <b>Čeština:</b> Provozní frekvence/maximální výstupní výkon <b>Ελληνικά:</b> Συχνότητα λειτουργίας/Μένιστη Ισχύς Εξόδου <b>Română:</b> Frecvența de funcționare/Puterea maximă de ieșire <b>Български:</b> Работна честота/максимална изходна мощност <b>Eesti:</b> Töösagedus/Max väljundvõimsus <b>Slovenščina:</b> Delovna frekvenca/Največja izhodna moč <b>Slovenčina:</b> Prevádzková frekvencia/maximálny výstupný výkon <b>Hrvatski:</b> Radna frekvencija/Maksimalna izlazna snaga <b>Latviešu:</b> Operējošās frekvences/Maksimālā jauda <b>Lietuvių:</b> Darbinis dažnis/maksimali išėjimo galia <b>Türkçe:</b> Çalışma Frekansı/Maks. Çıkış Gücü <b>عربي:</b> تردد التشغيل / الحد الأقصى لطاقة الإخراج	2412MHz-2472MHz/20dBm 5150MHz-5250MHz (indoor use only)/23dBm (X2LR Pro) 5150MHz-5350MHz (indoor use only)/23dBm (X12LR Pro)
--	--

# IC RSS Warning

This device complies with Innovation, Science and Economic Development Canada licence-exempt RSS standard (s). Operation is subject to the following two conditions:

- (1) this device may not cause interference, and
  - (2) this device must accept any interference, including interference that may cause undesired operation of the device.
- Le onjunc areil est conforme aux CNR d' l'innovation, la science et le développement économique Canada licables aux areils radio exempts de licence. L'exploitation est autorisée aux deux conditions suivantes:
- (1) l'areil ne doit pas produire de brouillage, et
  - (2) l'utilisateur de l'appareil doit accepter tout brouillage radioélectrique subi, onj si le brouillage est susceptible d'en compromettre le fonctionnement.

Any changes or modifications not expressly approved by the party responsible for compliance could void the user's authority to operate the equipment.  
Tous les changements ou modifications non expressément approuvée par le responsable de la conformité pourrait vider l'utilisateur est habilité à exploiter l'équipemen.

ISED Radiation Exposure Statement:  
This equipment complies with ISED RF radiation exposure limits set forth for an uncontrolled environment. This transmitter must not be co-located or operating in conjunction with any other antenna or transmitter. This equipment should be installed and operated with minimum distance 20cm between the radiator& your body  
Cet appareil est:  
conforme aux limitesd'exposition de rayonnement RF ISED établiespour un environnement non contrôlé. Cetémetteur ne doit pas être co-implanté oufonctionner en onjunction avec toute autreantenne ou transmetteur. La distance entre le radiateur et le corps doit être d'au moins 20 cm lors de l'installation et du fonctionnement de l'appareil.

Operation of 5150-5350MHz is restricted to indoor use only.  
le fonctionnement de 5150-5350MHz est limité à une utilisation en intérieur uniquement.

### Technical Support

Shenzhen IP-COM Networks Co., Ltd.  
Address: Room 101, Unit A, First Floor, Tower E3, No.1001, Zhongshanyuan Road, Nanshan District, Shenzhen, China. 518052  
Email: [info@ip-com.com.cn](mailto:info@ip-com.com.cn)  
Website: [www.ip-com.com.cn](http://www.ip-com.com.cn)

### Copyright ©2025 IP-COM Networks Co., Ltd. All rights reserved.

This documentation (including pictures, images, and product specifications, etc.) is for reference only. To improve internal design, operational function, and/or reliability, IP-COM reserves the right to make changes to the products described in this document without obligation to notify any person or organization of such revisions or changes.

V1.2 Keep for future reference.