

Tenda

Quick Installation Guide

4G LTE Mobile Wi-Fi
MF6/4G185

Package contents



Get to know your device

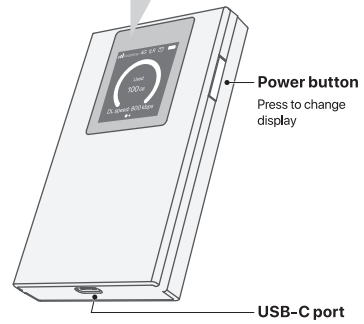
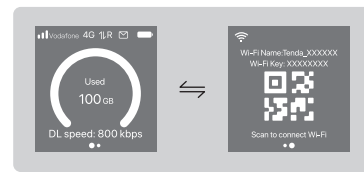

- Tips**
- When the battery icon on the screen turns red, charge the mobile Wi-Fi in time.
 - The LCD screen will automatically turn off after the mobile Wi-Fi stays on standby for 10 seconds. To activate the mobile Wi-Fi, press the Power button.

Connect to the Internet

1 Open the back cover.

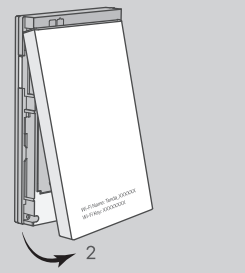
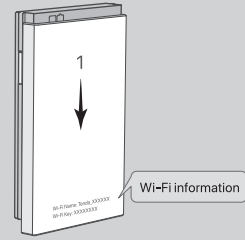

2 Slide the SIM card into the slot.



3 Install the battery.

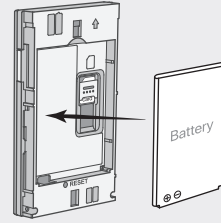

4 Close the back cover.

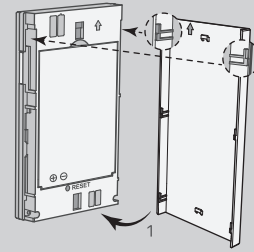

5 Press the button for about 2 seconds until the LCD screen lights up.

6 Connect the smartphone to the Wi-Fi.



You can log in to the web UI by visiting tendawifi.com to further configure the mobile Wi-Fi.

- Tips**
- If no client connects to the mobile Wi-Fi within 10 minutes, the mobile Wi-Fi will disable the Wi-Fi. To enable it, press the Power button.

Charge your mobile Wi-Fi

Method 1

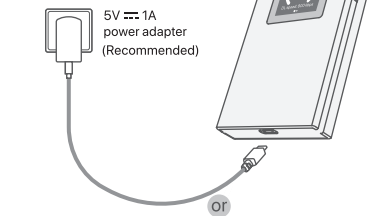

Method 2



- Tips**
- Use the standard power adapter by yourself to protect the battery.

Battery warnings

DO NOT use it above 35°C

REMOVE battery if device is always active and charged

AVOID overdischarging

AVOID overcharging

Keep away from heat sources

Replace a degraded battery

FAQ



Scan the QR code to get your questions answered about mobile Wi-Fi.

Get support and services



<https://www.tendacn.com/service/default.html>

Visit the product page or service page on www.tendacn.com.

- For more details about connecting to the Internet (see **Installation Guide**).
- For technical specifications, user guides, GNU General Public License Notice and more information. Multiple languages are available.

You can see the product name and model on the product label.

Safety precautions

Before operating, read the operation instructions and precautions to be taken, and follow them to prevent accidents. The warning and danger items in other documents do not cover all the safety precautions that must be followed. They are only supplementary information, and the installation and maintenance personnel need to understand the basic safety precautions to be taken.

- Operating temperature: 0°C–35°C (32°F–95°F).
- Do not use the device in a place where wireless devices are not allowed.
- Keep the device away from water, fire, high electric field, high magnetic field, and inflammable and explosive items.
- Do not use the USB-C cable if its plug or cord is damaged.
- If the device is found to be hot, shut down in time.
- Use 5V DC 1A genuine power adapter that meets safety standards. Keep the charging port dry. Do not place charging devices on beds, pillows, mattresses or blankets as there is a risk of fire. Unplug the power adapter in time after the charging is completed. Disconnect the power source during servicing.
- If such phenomena as smoke, abnormal sound, smell appear or swollen battery when you use the device, immediately stop using it and disconnect its power supply, unplug all connected cables, and contact the after-sales service personnel.
- Disassembling or modifying the device or its accessories without authorization voids the warranty, and might cause safety hazards.
- If you need to use the device with a power supply device always connected, remove the battery for protection to extend its lifespan.
- The security and lifespan of the battery can be affected by: the use of fast charging, prolonged use while charging, charging continuously for more than 48 hours or placing the device in a high temperature environment (> 35°C).
- Keep this device out of reach of children to prevent children from using it as a toy and causing personal injury.
- Refer all servicing to qualified service personnel.
- The device's marking information can be found after removing the battery.

CAUTION
RISK OF EXPLOSION IF BATTERY IS REPLACED BY AN INCORRECT TYPE.
DISPOSE OF USED BATTERIES ACCORDING TO LOCAL REGULATIONS

For the latest safety precautions, see **Safety and Regulatory Information** on www.tendacn.com.

English-Frequency bands and power

Some frequency bands in which the radio equipment operates may not be available in some countries or areas. Please contact your local ISP for more details.

The maximum radio-frequency power transmitted in the frequency bands in which the radio equipment operates is less than the highest limit value specified in the related Harmonized Standard. The frequency bands and transmitting power (radiated and/or conducted) nominal limits applicable to this radio equipment are as follows:

Band:
4G LTE Band: B1/B3/B5/B7/B8/B20/B38/B40/B41;
LTE Power: 23 ± 2 dBm

Italiano-Bande di frequenza e potenza

Alcune bande di frequenza in cui opera l'apparecchiatura radio potrebbero non essere disponibili in alcuni paesi o aree. Si prega di contattare l'ISP locale per ulteriori dettagli. La massima potenza di radiofrequenza trasmessa nelle bande di frequenza in cui opera l'apparecchiatura radio è inferiore al valore limite massimo specificato nella relativa norma armonizzata. Le bande di frequenza e i limiti nominali della potenza di trasmissione (irradiata e/o condotta) applicabili a questa apparecchiatura radio sono i seguenti:

Band:
Bande 4G LTE: B1/B3/B5/B7/B8/B20/B38/B40/B41;
Potenza LTE: 23 ± 2 dBm

Français-Bandes de fréquence et puissance

Certaines bandes de fréquences dans lesquelles l'équipement radio fonctionne peuvent ne pas être disponibles dans certains pays ou régions. Veuillez contacter votre FAI local pour plus de détails. La puissance radioélectrique maximale transmise dans les bandes de fréquences dans lesquelles l'équipement radioélectrique fonctionne est inférieure à la valeur limite la plus élevée spécifiée dans la norme harmonisée correspondante.

Les limites nominales des bandes de fréquences et de la puissance d'émission (rayonnée et/ou conduite) applicables à cet équipement radio sont les suivantes :

Groupe:
Bande 4G LTE: B1/B3/B5/B7/B8/B20/B38/B40/B41;
Puissance LTE: 23 ± 2 dBm

Español-Bandas de frecuencia y potencia

Algunas bandas de frecuencia en las que opera el equipo de radio pueden no estar disponibles en algunos países o áreas. Póngase en contacto con su ISP local para obtener más detalles. La potencia máxima de radiofrecuencia transmitida en las bandas de frecuencia en las que opera el equipo de radio es inferior al valor límite más alto especificado en la Norma armonizada correspondiente. Las bandas de frecuencia y los límites nominales de potencia de transmisión (radiada y/o conducida) aplicables a este equipo de radio son los siguientes:

Bandas:
Banda 4G LTE: B1/B3/B5/B7/B8/B20/B38/B40/B41;
Potencia LTE: 23 ± 2 dBm

Deutsch-Frequenzbänder und Leistung

Einige Frequenzbänder, in denen das Funkgerät betrieben wird, sind in manchen Ländern oder Gebieten möglicherweise nicht verfügbar. Für weitere Einzelheiten wenden Sie sich bitte an Ihren ISP vor Ort. Die maximale Hochfrequenzleistung, die in den Frequenzbändern übertragen wird, in denen die Funkausrüstung betrieben wird, liegt unter dem höchsten Grenzwert, der in der entsprechenden harmonisierten Norm festgelegt ist.

Die für dieses Funkgerät geltenden Nenngrenzen für Frequenzbänder und Sendeleistung (abgestrahlt und/oder leitungsgebunden) sind wie folgt:

Band:
4G LTE-Band: B1/B3/B5/B7/B8/B20/B38/B40/B41;
LTE-Leistung: 23 ± 2 dBm

Vietnamese-Dải tần và công suất

Một số băng tần mà thiết bị vô tuyến hoạt động có thể không khả dụng ở một số quốc gia hoặc khu vực. Vui lòng liên hệ với ISP địa phương của bạn để biết thêm chi tiết. Công suất tần số vô tuyến tối đa được truyền trong các dải tần mà thiết bị vô tuyến hoạt động nhỏ hơn giá trị giới hạn cao nhất được quy định trong Tiêu chuẩn hài hòa liên quan.

Các giới hạn danh định về dải tần và công suất phát (bức xạ và/hoặc dẫn) áp dụng cho thiết bị vô tuyến này như sau:

Băng tần 4G LTE: B1/B3/B5/B7/B8/B20/B38/B40/B41;
Công suất LTE: 23 ± 2 dBm

عربي - نطاقات التردد والطاقة

قد لا تتوفر بعض نطاقات التردد التي يعمل بها الجهاز الراديوي في بعض البلدان أو المناطق. يرجى الاتصال بمزود خدمة الإنترنت المحلي لمزيد من التفاصيل.

الحد الأقصى لثقة التردد الراديوي المرسل في نطاقات التردد التي يعمل فيها الجهاز الراديوي أقل من أعلى قيمة حدية محددة في المعيار المنسق ذي الصلة.

نطاقات التردد وفترة الإرسال (المشعة و / أو الموصلة) الحدود الاسمية المطبقة على هذا الجهاز الراديوي هي كما يلي:

بلي:
نطاق 4G LTE: B1/B3/B5/B7/B8/B20/B38/B40/B41
السلطة LTE: 23 ± 2 ديسيل

CE mark warning

This is a Class B product. In a domestic environment, this product may cause radio interference, in which case the user may be required to take adequate measures. This device should be installed and operated with a minimum distance 5 mm between the device and your body. NOTE: (1) The manufacturer is not responsible for any radio or TV interference caused by unauthorized modifications to this equipment. (2) To avoid unnecessary radiation interference, it is recommended to use a shielded USB-C cable.

Declaration of conformity
Hereby, SHENZHEN TENDA TECHNOLOGY CO., LTD. declares that the device (Mobile Wi-Fi) is in compliance with Directive 2014/53/EU. The full text of the EU declaration of conformity is available at the following Internet address: <https://www.tendacn.com/download/list-9.html>

| | |
|--|-----------------------|
| English: Operating Frequency/Max Output Power | 2412MHz-2472MHz/20dBm |
| Deutsch: Betriebsfrequenz/Max. Ausgangsleistung | |
| Italiano: Frequenza operativa/Potenza di uscita massima | |
| Español: Frecuencia operativa/Potencia de salida máxima | |
| Français: Fréquence de fonctionnement/Puissance de sortie maximale | |
| عربي: تردد التشغيل / الحد الأقصى لطاقة الإخراج | |

RECYCLING

This product bears the selective sorting symbol for Waste Electrical and Electronic Equipment (WEEE). This means that this product must be handled pursuant to European directive 2012/19/EU in order to be recycled or dismantled to minimize its impact on the environment. User has the choice to give his product to a competent recycling organization or to the retailer when he buys a new electrical or electronic equipment.

Caution:

Battery Model: 4G Capacity: 2100mAh 7.98Wh
Voltage: 3.8V Limited charge voltage: 4.35V
Manufacturer: Phenix New Energy (Hui Zhou) Co., Ltd



Technical support

Shenzhen Tenda Technology Co., Ltd.
Floor 6-8, Tower E3, No.1001, Zhongshanyuan Road, Nanshan District, Shenzhen, China. 518052
Website: www.tendacn.com
E-mail: support@tenda.com.cn
support.uk@tenda.cn (United Kingdom)
support.us@tenda.cn (North America)

Copyright © 2024 Shenzhen Tenda Technology Co., Ltd. All rights reserved. Tenda is a registered trademark legally held by Shenzhen Tenda Technology Co., Ltd. Other brand and product names mentioned herein are trademarks or registered trademarks of their respective holders. Specifications are subject to change without notice. V1.0 Keep for future reference.